

# "H" STREET

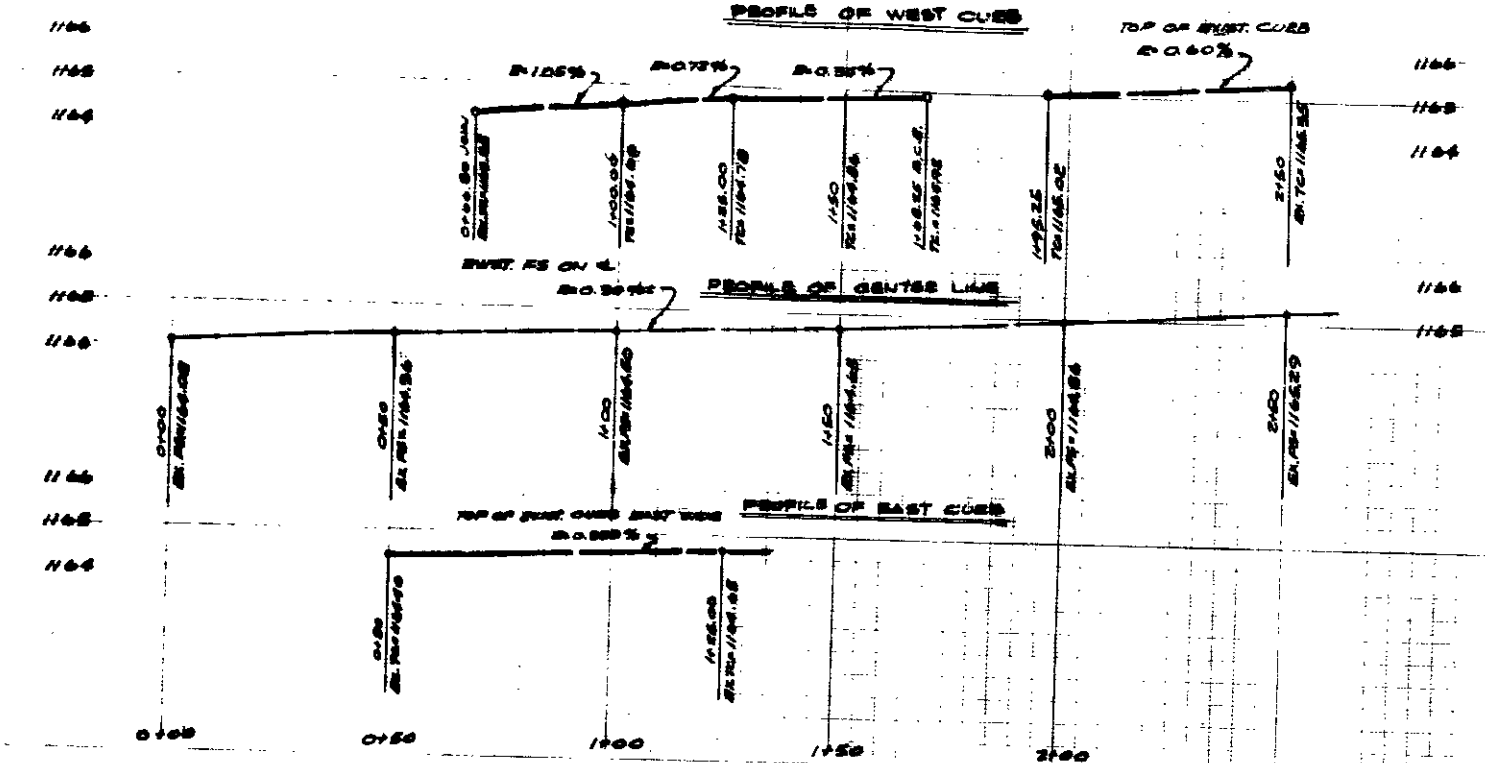

PROFILE SCALE:  
HORIZ. 1"=20'  
VERT. 1"=2'

**ESTIMATE OF QUANTITIES:**

1. CONC. CURB & GUTTER	101.50	LN. FT.
2. CONC. CURB & GUTTER RETURN (R&R)	36	LN. FT.
3. CONC. CROSS GUTTER (3" WIDE)	78	SQ. FT.
4. CONC. DRIVEWAYS	1,315	SQ. FT.
5. CONC. SIDEWALK	755	SQ. FT.
6. 3" P.H.S. ON 6" AGG. BASE	155	SQ. YD.
7. 4" O.D. DRAIN PIPE	74	LN. FT.

TYPICAL SECTION OF "H" STREET  
NO SCALE

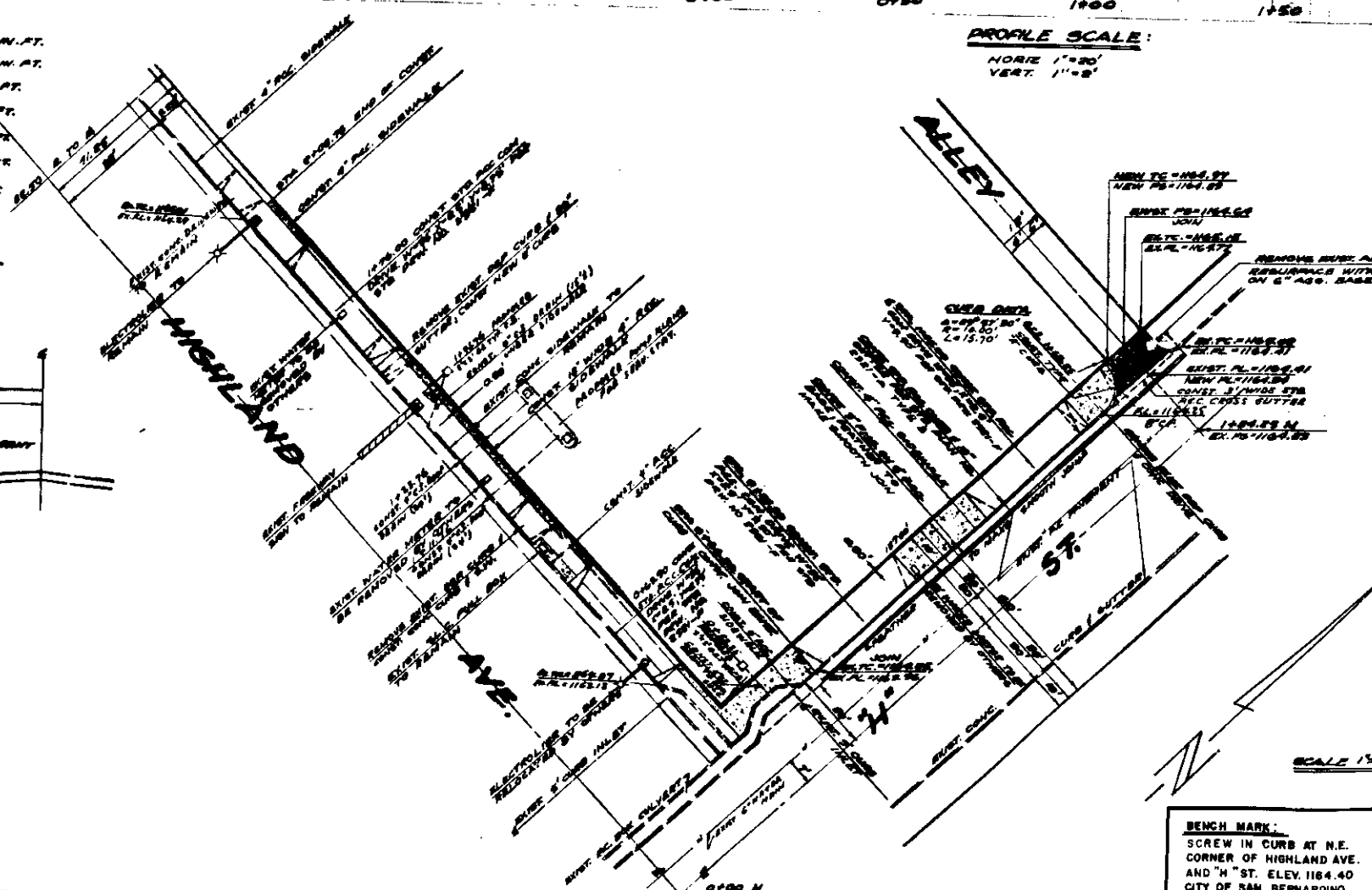
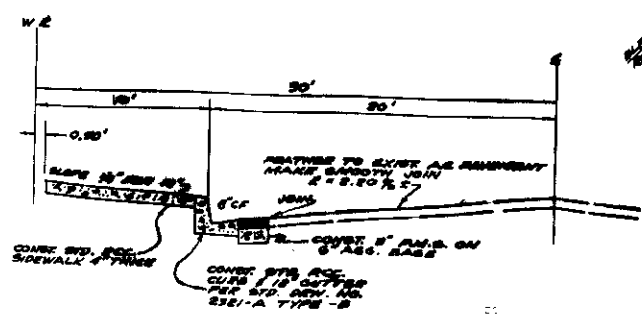

## GENERAL NOTES:

1. ALL WORK EMBODIED ON THIS PLAN SHALL BE DONE IN ACCORDANCE WITH APPLICABLE PROVISIONS OF STANDARD SPECIFICATIONS FOR ROAD AND BRIDGE CONSTRUCTION ON FILE IN THE OFFICE OF THE CITY ENGINEER.
2. CURB & GUTTER ARE AS PER CITY OF SAN BERNARDINO ENGINEERING STD. DRWG. NO. 2281.
3. DRIVEWAYS TO BE CONST. PER CITY OF SAN BERNARDINO ENGINEERING STD. DRWG. NO. 2281.
4. THE EXISTENCE AND LOCATION OF ANY UNDERGROUND OR STRUCTURES SHOWN ON THESE PLANS ARE OBTAINED FROM THE AVAILABLE RECORDS TO THE BEST OF OUR KNOWLEDGE. THERE ARE NO EXISTING UTILITIES EXCEPT AS SHOWN ON THESE PLANS. THE CONTRACTOR IS REQUIRED TO TAKE DUE PRECAUTION TO PROTECT THE UTILITY LINES SHOWN AND ANY OTHER LINES NOT SHOWN ON THIS DRAWING.
5. SOIL TESTS BY A RECOGNIZED SOIL TESTING LAB SHALL BE REQUIRED TO DETERMINE THE ADEQUACY OF THE EXISTING SUBGRADE. IF THE RESULTS OF THE TESTS SHOW THE EXISTING SUBGRADE IS NOT SUFFICIENT BASE MATERIAL SHALL BE PLACED ON THE INDICATED SURFACING AND OR THE SURFACING THICKNESS SHALL BE INCREASED.
6. A PERMIT SHALL BE OBTAINED FROM STATE DIV. OF HIGHWAYS BEFORE STARTING WORK ON HIGHLAND AVE. AS SHOWN ON THE PLAN.

DEPARTMENT OF ENGINEERING  
CITY OF SAN BERNARDINO

"H" STREET (WEST SIDE) FROM HIGHLAND AVE. TO 178 FEET NORTH AND HIGHLAND AVE. (NORTH SIDE) FROM "H" STREET TO 209 FEET WEST OF "H" ST.

OXFORD 6-2256

BENCH MARK: SCREW IN CURB AT N.E. CORNER OF HIGHLAND AVE. AND "H" ST. ELEV. 1164.40 CITY OF SAN BERNARDINO DATUM.

DESIGNED L. D. LEEPER	APPROVED L. D. LEEPER
DRAWN R. J. B.	DATE JUNE 5, 1964
CHECKED L. D. L.	SCALE AS SHOWN
JOB NO.	RCE NO. 1795

PREPARED IN THE OFFICE OF:  
L. D. LEEPER & ASSOCIATES  
508 S. GREENLEAF AVENUE  
WHITTIER, CALIFORNIA

APPROVED: [Signature] CITY ENGINEER

SUBMITTED BY: [Signature] DATE: June 11, 1964

REFERENCE: [Blank]

CHECKED BY: [Blank]